

comfy buckley

FROM \$81,500+ GST



SIZE: L 6000mm x W 3500mm = 21m²
(Custom Sizes Available)

STANDARD INCLUSIONS

- Construction Compliance
- Footings
- Steel Base
- Structural Timber Frame
- Fully Insulated Roof, Walls & Base
- Colorbond Roof With Matching Flashings
- Single Glazed Aluminum Door & Windows
- x1 Sliding Door Flyscreens
- x2 Awning Windows
- Flyscreens To Door & Windows
- Colorbond Corrugated Cladding
- James Hardie Axon Fibre Cement Sheet Cladding To Front
- Gyprock Plaster With Square Set Cornices
- Hybrid Floorboards Throughout With Vinyl Flooring To Wet Areas
- Pine Bevelled Edge Skirts And Architraves
- Clipsal Iconic Electrical Range
 - x3 Light Switch
 - x6 Internal Power Points
 - x8 Internal Down Lights
 - x2 External Lights
 - x1 Externally Vented Fan
 - x1 Smoke Detector
 - x1 120l Hotwater service
- Composite Deck Step Width Of Opening Door

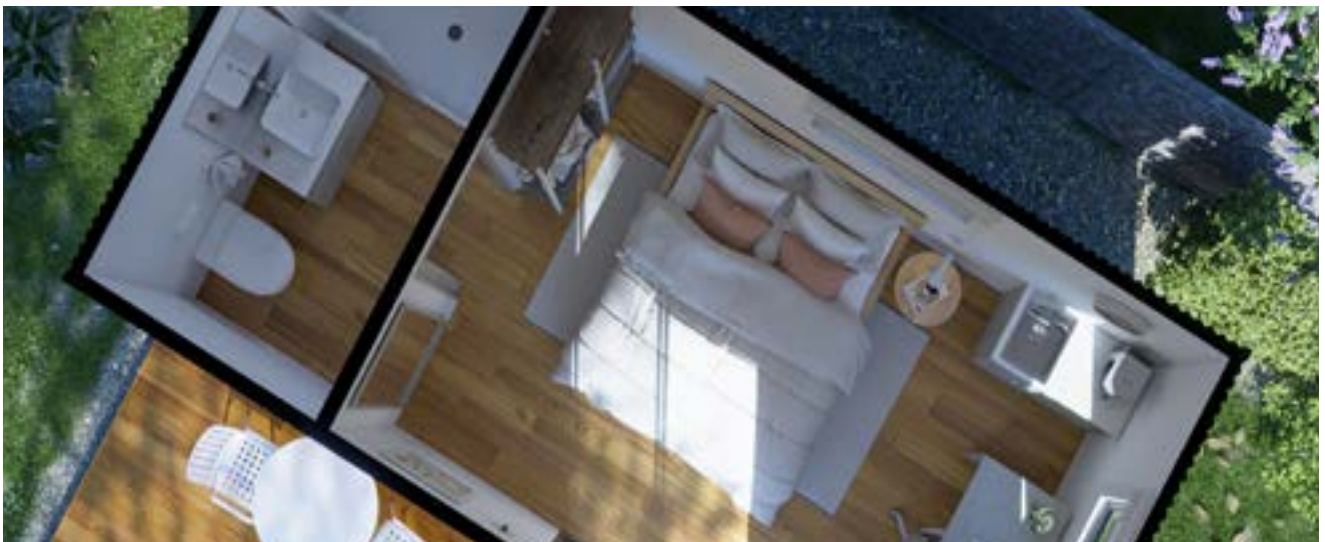
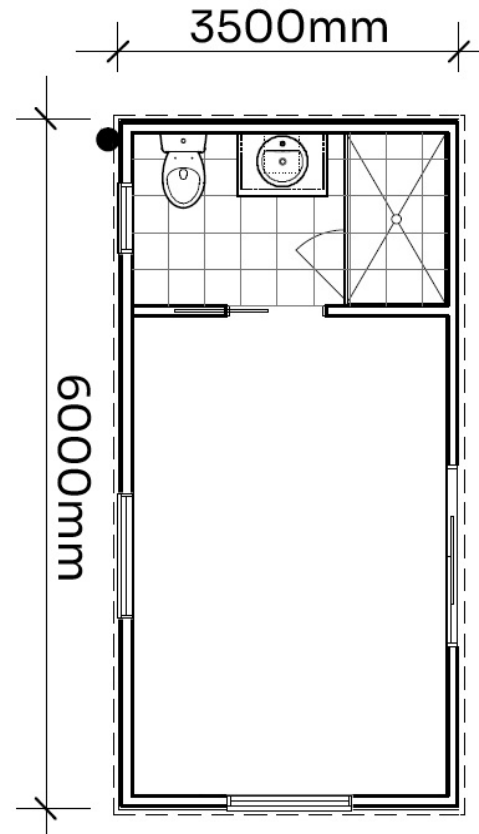

* Standard Unit price. All prices quoted are exclusive of GST and exclude external consultants, permit fees, delivery to site and site works. ComfyPod reserve the right to make modifications to the plans, specifications, and dimensions if so required.